

# R-TEC Smart Controls - ARC™ USB Signal Repeater RTMUSR



ARC™ USB Signal Repeaters extend the wireless range of the R-TEC Hub or Remotes up to 60'. Maximum of 2 repeaters per system or network.

Simply plug into USB Wall Charger for easy install.

In some instances, the remote signal may not reach all motors; simply plug in the ARC™ repeater near the suspected out of range motors. If you have an instance whereby not all motors are responding or responding intermittently, the ARC™ repeater will double the range you currently get.

## FEATURES

---



2-Way RF  
Communication



Extends the Wireless  
Range up to 60'

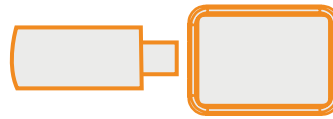

Easy Installation with  
USB Wall Charger



Simple Test  
Function

## FACTORS THAT AFFECT YOUR RANGE

---

- Metal is the biggest factor that affects your range; even if there is a metal roof, the remote signal bounces around the house and a metal roof absorbs the signal.
- Solid Brick walls will heavily affect the range and absorb and reduce the signal.
- Wall tiles and glass.
- Other metal frames' electrical cables.
- Microwave signal; even a residential microwave will shorten the range (while its running).

# TABLE OF CONTENTS

Technical Data / Pack Contents	3
Safety	4
Installation	5
Range	
Functional Overview	5
LED Light Indication	
Programming	6

# COMPLIANCE STATEMENT

This device complies with part 15 of the FCC Rules. Operation is subject to the following two conditions:

- This device may not cause harmful interference.
- This device must accept any interference received, including interference that may cause undesired operation.

---

## TECHNICAL DATA / PACK CONTENTS

### PRODUCT SPECIFICATIONS

Parameters	Value
Voltage	5±0.2 V DC
Power Supply	USB Wall Charger (sold separately)
Radio Frequency	433.92 MHz
Transmitting Power	3 - 3.5 dBm
Transmission Range	Extends the wireless range of the R-TEC Hub and Remotes up to 60'. Maximum of 2 per system or network.
Temperature Working Range	23° F - 122° F (-5° C - 50° C)

---

### PACK CONTENTS

1. USB Signal Repeater (Wall Charger RTMLWCW sold separately)
2. Instruction Manual

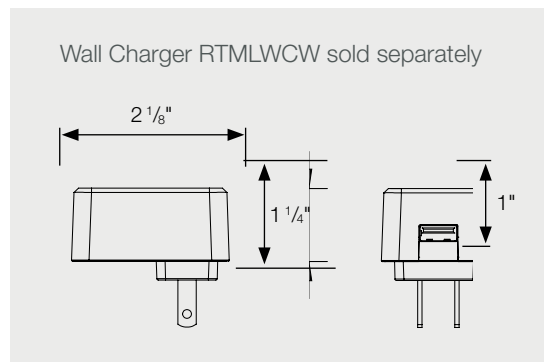
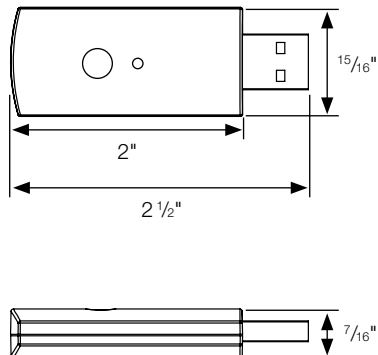

# SAFETY



## WARNING

Any changes or modifications to this unit not expressly approved by the party responsible for compliance could void the user's authority to operate the equipment. Incorrect installation can lead to serious injury and will void manufacturer's liability and warranty.

## CAUTION

- Do not expose to moisture or extreme temperatures.
- Do not allow children to play with this device.
- Use or modification outside the scope of this instruction manual will void warranty.
- Installation and programming to be performed by a suitably qualified installer.
- Use only R-TEC Automation® hardware.
- Keep clear when in operation.
- Replace battery with correctly specified type.

## IMPORTANT SAFETY INSTRUCTIONS TO BE READ PRIOR TO OPERATION

- It is important for the safety of persons to follow the enclosed instructions. Save these instructions for future reference.
- Persons (including children) with reduced physical, sensory or mental capabilities, or lack of experience and knowledge should not be allowed to use this product.
- Frequently inspect for improper operation. Do not use if repair or adjustment is necessary.
- Keep away from children.



Do not dispose of in general waste.

Please recycle batteries and damaged electrical products appropriately.



# INSTALLATION

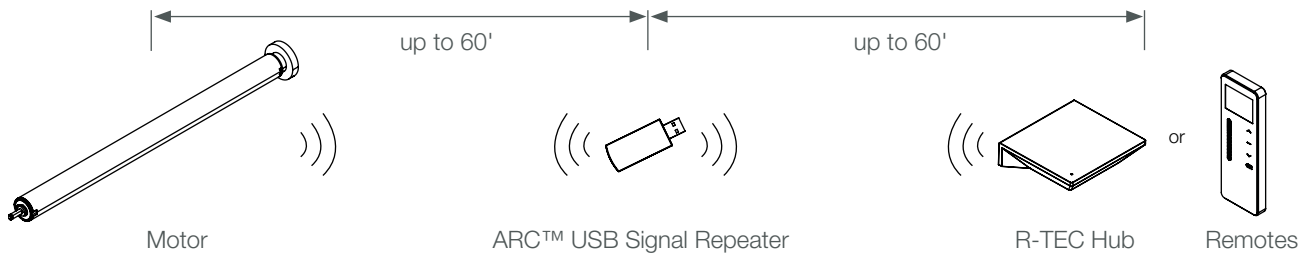

## RANGE

The USB Signal Repeater extends the wireless range of the R-TEC Hub and Remotes up to 60'. Max. 2 per system or network.



# FUNCTIONAL OVERVIEW

## LED LIGHT INDICATION

Color	LED	Status
	On	Power On
	Flashes x 3	Transmitting a remote control, motor or sensor RF433 MHz signal
	Flashes x 1	Transmitting an R-TEC Hub RF433 MHz signal

# PROGRAMMING



## IMPORTANT

Maximum of 2 USB Signal Repeaters can be used in one project. Don't cover the USB Signal Repeater with a metal shield.

---

## QUICK START GUIDE

- 1 Plug USB Wall Charger (sold separately) into a power outlet.

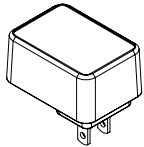

- 2 Plug the USB Signal Repeater into the USB Wall Charger (sold separately). A blue LED on the USB Signal Repeater will be visible when the power is switched on.

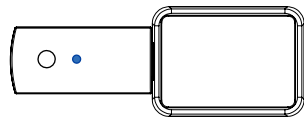

- 3 Press any button on an R-TEC remote control. The blue light on the USB Signal Repeater will flash 3 times. This means the USB Signal Repeater is transmitting the signal.

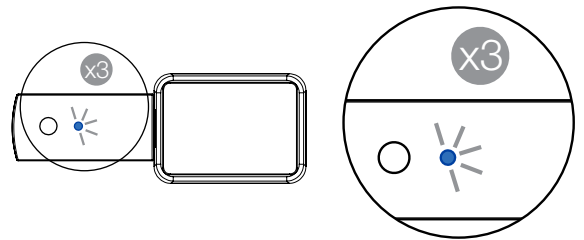

## WARNING

Only use our R-TEC USB Wall Charger RTMLWCW with your USB Signal Repeater. Using other wall chargers / power sources may adversely affect USB Signal Repeater's performance and should be avoided.

---

### Any Questions?

Contact our R-TEC Automation® in-house experts at 866.985.3423. Email us at [RTECAutomation@RowleyCompany.com](mailto:RTECAutomation@RowleyCompany.com).