

Rechargeable Battery Pack RTMDCRBP



Rechargeable Battery Pack - The rechargeable Li-ion Battery Pack enables DC Tubular Motors to operate wirelessly and without the constraints of traditional battery wands with disposable batteries.

The small profile allows for optimal placement in the window pocket, fully recharges in about 6 hours and can be paired with the optional Solar Panel Battery Charger for continuous recharging.

FEATURES



Up to 500
Up / Down Cycles
on Single Charge



Small
Profile



Battery Health
Status in R-TEC
Automation[®] App



Recharges
in 6 hours



Optional Solar
Panel for Continuous
Recharging

SAFETY INSTRUCTIONS

WARNING: Important safety instructions to be read before installation.

Incorrect installation can lead to serious injury and will void manufacturer's liability and warranty.

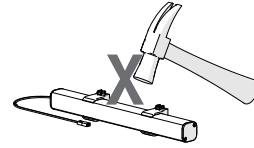
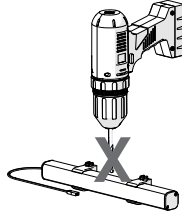

WARNING: Important safety instructions to be read before installation and use.

Incorrect installation or use can lead to serious injury and will void manufacturer's liability and warranty.

It is important for the safety of persons to follow the enclosed instructions. Save these instructions for future reference.

- Do not expose to water, moisture, humid and damp environments or extreme temperatures.
- Persons (including children) with reduced physical, sensory or mental capabilities, or lack of experience and knowledge should not be allowed to use this product.
- Use or modification outside the scope of this instruction manual will void warranty.
- Installation and programming to be performed by a suitably qualified installer.
- Follow installation instructions.
- For use with motorized shading devices.
- Keep away from children.
- Frequently inspect for improper operation. Do not use if repair or adjustment is necessary.
- Keep clear when in operation.
- Replace battery with correctly specified type.

COMPLIANCE STATEMENT

This device complies with Part 15 of the FCC Rules / Industry Canada licence-exempt RSS standard(s). Operation is subject to the following two conditions:

- (1) this device may not cause harmful interference, and
- (2) this device must accept any interference received, including interference that may cause undesired operation.

Le présent appareil est conforme aux CNR d'Industrie Canada applicables aux appareils radio exempts de licence. L'exploitation est autorisée aux deux conditions suivantes:

- (1) l'appareil ne doit pas produire de brouillage, et
- (2) l'utilisateur de l'appareil doit accepter tout brouillage radioélectrique subi, même si le brouillage est susceptible d'en compromettre le fonctionnement.

Changes or modifications not expressly approved by the party responsible for compliance could void the user's authority to operate the equipment.

This equipment has been tested and found to comply with the limits for a Class B digital device, pursuant to part 15 of the FCC Rules. These limits are designed to provide reasonable protection against harmful interference in a residential installation.

This equipment generates uses and can radiate radio frequency energy and, if not installed and used in accordance with the instructions, may cause harmful interference to radio communications. However, there is no guarantee that interference will not occur in a particular installation.

If this equipment does cause harmful interference to radio or television reception, which can be determined by turning the equipment off and on, the user is encouraged to try to correct the interference by one or more of the following measures:

- Reorient or relocate the receiving antenna.
- Increase the separation between the equipment and receiver.
- Connect the equipment into an outlet on a circuit different from that to which the receiver is connected.
- Consult the dealer or an experienced radio/TV technician for help.

To satisfy FCC / IC RF exposure requirements, a separation distance of 20 cm or more should be maintained between the antenna of this device and persons during device operation.

To ensure compliance, operations at closer than this distance is not recommended.

Les antennes installées doivent être situées de façon à ce que la population ne puisse y être exposée à une distance de moins de 20 cm. Installer les antennes de façon à ce que le personnel ne puisse approcher à 20 cm ou moins de la position centrale de l'antenne.

La FCC des états-unis stipule que cet appareil doit être en tout temps éloigné d'au moins 20 cm des personnes pendant son fonctionnement.



Do not dispose of in general waste.
Please recycle batteries and damaged electrical products appropriately.



1 INSTALLATION

1.1 Charging

Charging uses the 2 pin locking “SMR” style connector.



IMPORTANT

Rechargeable Battery Pack must be fully charged prior to first use to prolong battery lifespan.

Charging Cable

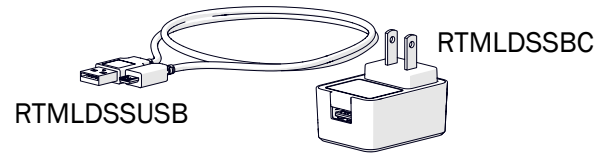

Step 1. Connect the Rechargeable Battery Pack to the Battery Charger.

RTMLDSSBC + RTMLDSSUSB

Step 2. Charge for 6 hours.

Step 3. Install as required.

See Section 1.2 Attachment Methods

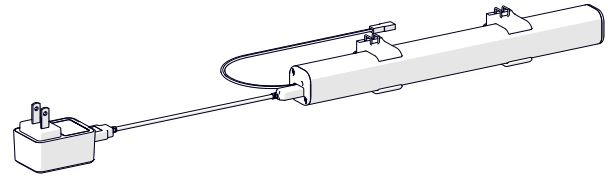

1.2 Attachment Methods

Hook

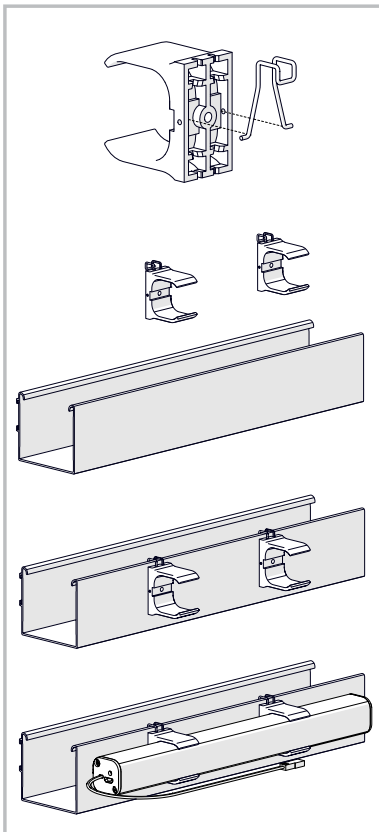

Screw

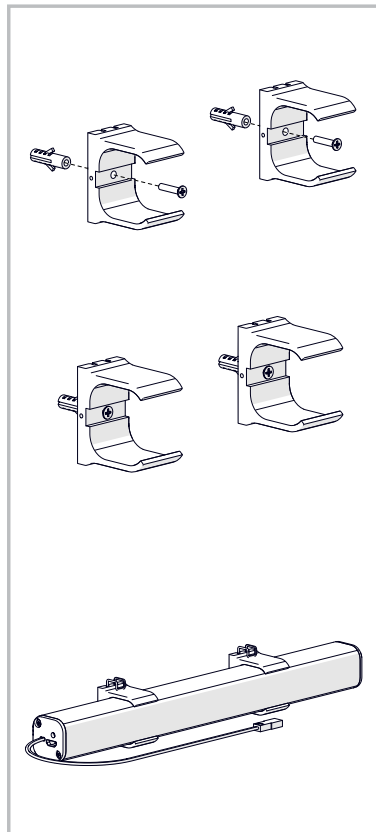

Double Sided Tape*

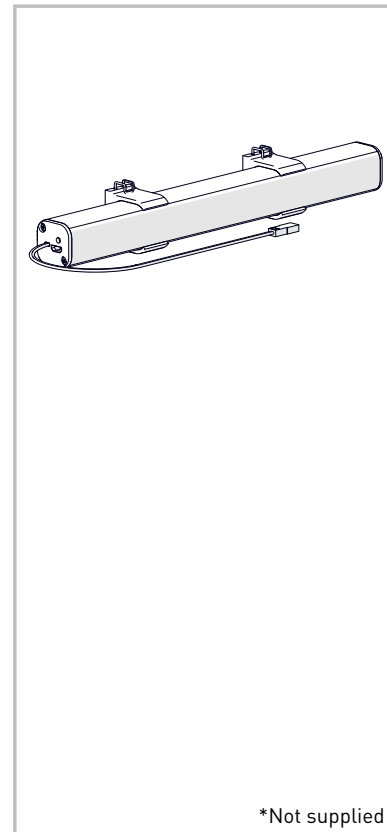

*Not supplied



IMPORTANT

Do not install Rechargeable Battery Pack where it will be exposed to direct sun light.

1.3 Motor Connections

Charging uses the 2 pin, non-locking "JST" style connector.

Motors

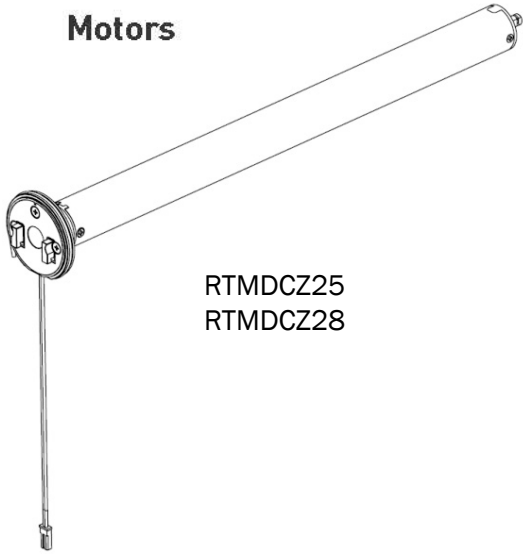

RTMDCZ25
RTMDCZ28

Motor Connection Cable

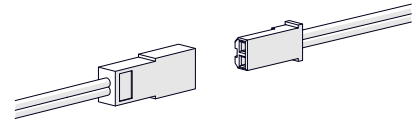

Any Questions?

Contact our R-TEC Automation® in-house experts at 866.985.3423. Email us at RTECAutomation@RowleyCompany.com.