

R-TEC Smart Controls - Surface Mount Wall Switch RTMWSR5C



Surface Mount Wall Switch in flush mount provides a sensible control option for individual window treatment, room and home control.

Available in 5 channel model, wall switches are compatible with all ARC motors.

Flush wall switches feature a contemporary design and a wirefree deployment, making them retrofit ready for any location. They can be mounted on top of any surface as either a fixed mount or magnetic mount. Its slim profile eliminates the need for any holes to be cut in walls.

FEATURES - 5 CHANNEL



2-Way RF
Communication



Multi Channel
Selectable



Retrofit
Ready

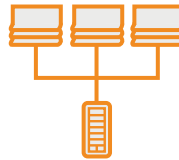

Group
Control



Optionally Functions as
a Handheld Remote

TABLE OF CONTENTS

Technical Data / Pack Contents	3
Safety	4
Installation	5 - 6
Kit Components	
Install Switch Batteries	
Magnetic Wall Clip	
Fixed Wall Clip	
Functional Overview	7
Buttons	
Selecting a Channel	
Programming	8 - 9
Using the P1 Button	
Using a Pre-Existing Controller	
Initial Set Up	10 - 11
Check Motor Direction	
Set Limits	
Locking the Limit Setting Function	
Adjusting Limits	12
Adjusting Upper Limit	
Adjusting Lower Limit	
Favorite Positioning	13
Set a Favorite Position	
Send Window Treatment to Favorite Position	
Delete Favorite Position	
Troubleshooting	14

COMPLIANCE STATEMENT

This device complies with part 15 of the FCC Rules. Operation is subject to the following two conditions:

- This device may not cause harmful interference.
- This device must accept any interference received, including interference that may cause undesired operation.

TECHNICAL DATA / PACK CONTENTS

PRODUCT SPECIFICATIONS

Parameters	Value
Voltage	3 V DC
Battery	CR2430
Radio Frequency	433.92 MHz
Transmitting Power	10 milliwatt
Transmission Range	65'
Temperature Working Range	14° F - 122° F (-10° C - 50° C)

PACK CONTENTS

1. Surface Mount Wall Switch, 5 Channel
2. Cover
3. Magnetic Wall Clip
4. Fixed Wall Clip
5. Pan Head Screws (2)
6. Phillips Head Screws (2)
7. Anchors (2)
8. 3 V - CR2450 Battery
9. Instruction Manual

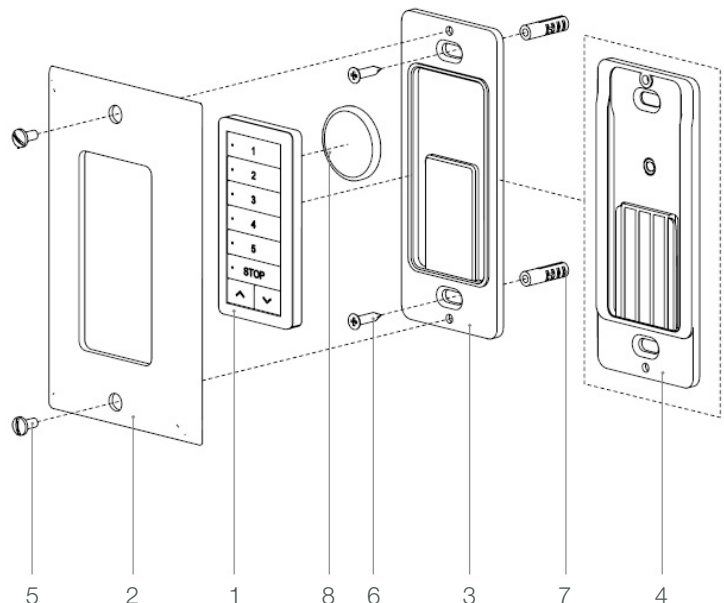

SAFETY



WARNING

Any changes or modifications to this unit not expressly approved by the party responsible for compliance could void the user's authority to operate the equipment. Incorrect installation can lead to serious injury and will void manufacturer's liability and warranty.

CAUTION

- Do not expose to moisture or extreme temperatures.
- Do not allow children to play with this device.
- Use or modification outside the scope of this instruction manual will void warranty.
- Installation and programming to be performed by a suitably qualified installer.
- Use only R-TEC Automation® hardware.
- Keep clear when in operation.
- Replace battery with correctly specified type.

IMPORTANT SAFETY INSTRUCTIONS TO BE READ PRIOR TO OPERATION

- It is important for the safety of persons to follow the enclosed instructions. Save these instructions for future reference.
- Persons (including children) with reduced physical, sensory or mental capabilities, or lack of experience and knowledge should not be allowed to use this product.
- Frequently inspect for improper operation. Do not use if repair or adjustment is necessary.
- Keep away from children.



Do not dispose of in general waste.

Please recycle batteries and damaged electrical products appropriately.



INSTALLATION

INSTALL SWITCH BATTERIES

Open rear battery cover by gently separating switch covers with screwdriver.

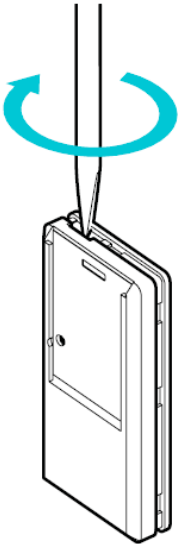

Install CR2430 battery with positive (+) side facing up. Snap covers back together.

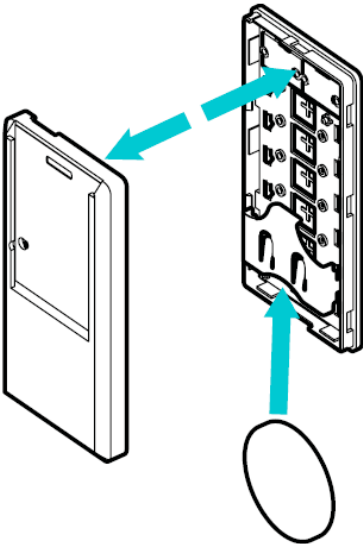

Snap covers back together.

MAGNETIC WALL CLIP

Use the Magnetic Wall Clip if you require the remote to be easily detachable.

Best Practice Tip:

Pair the Switch to the motor prior to installation, then test radio performance in the location the switch will be installed in, to ensure best performance.

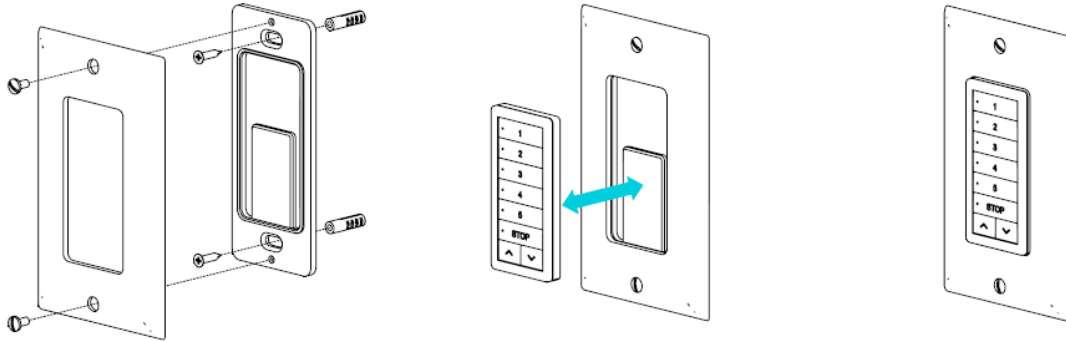

1. Use supplied fasteners and anchors as needed to attach the base and cover.
2. Switch is held in position magnetically and can be removed as desired.
3. Safely dispose of the unused Fixed Wall Clip.

FIXED WALL CLIP

Use the Fixed Wall Clip if you require the remote to be non-removable.

Best Practice Tip:

Pair the Switch to the motor prior to installation, then test radio performance in the location the switch will be installed in, to ensure best performance.

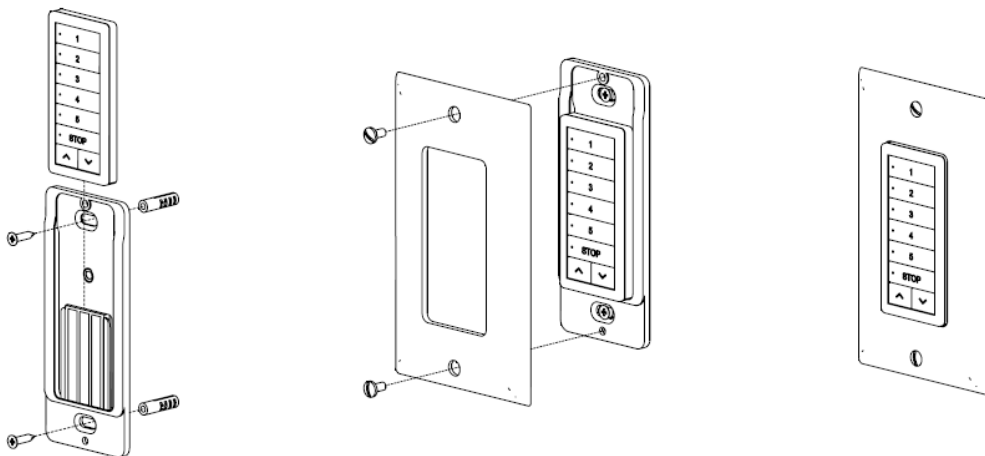

1. Slide the Switch onto the Wall Clip.
2. Use supplied fasteners and anchors as needed to attach the base and cover.
3. Switch is secured unless the Cover is removed.
4. Safely dispose of the unused Magnetic Wall Clip.

FUNCTIONAL OVERVIEW

BUTTONS

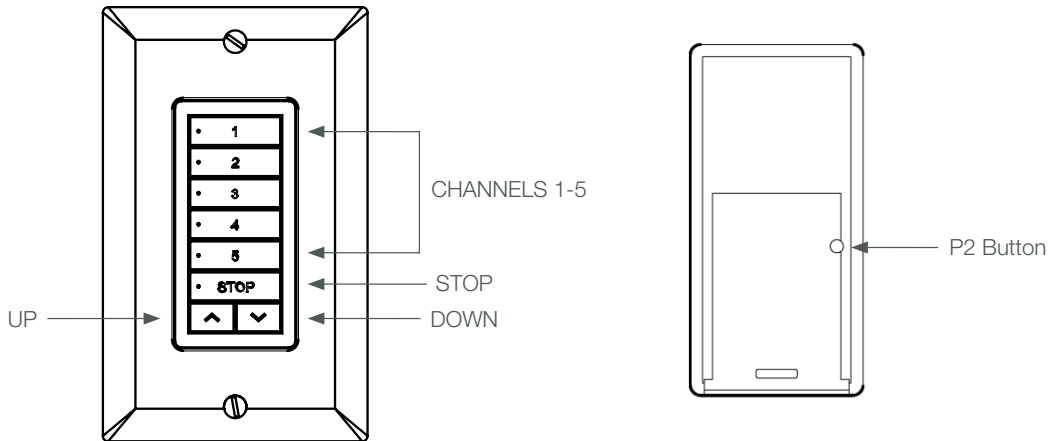

SELECTING A CHANNEL



IMPORTANT

To determine which channel is activated prior to programming or operating the control simply press and release any of the 'channel' buttons or the 'stop' button once and the active channel or channels will illuminate.



IMPORTANT

You can program one channel at a time but you can operate several channels at once if desired after the programming has been completed.

Select a channel by 'toggling' it on until a blue LED is showing next to it. This will require pressing and releasing the channel once or twice until the light appears.

Deselect the channels that you don't want to be active by 'toggling' them off until the blue LED disappears.

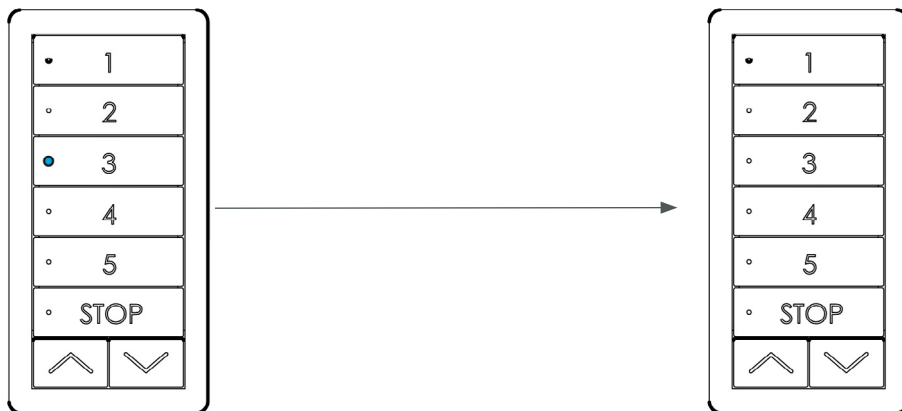

Motor Response
Blue LEDs will illuminate indicating channel selection.

Now only the channel that you want to program or operate will be active. Your selected channel is now ready to be programmed or operated.



IMPORTANT

When a channel is selected, the blue LED will stay illuminated for four seconds and then go out. The channel remains active. Programming and operation of the window treatment(s) on the channel can proceed without reselecting the channels.

PROGRAMMING

USING MOTOR P1 BUTTON



IMPORTANT

Multiple motors can be grouped onto shared channels for coordinated control.

- Confirm that motor limits and favorite position are already set for each individual motor.
- Ensure that each motor you want to group is also assigned to another channel by itself.

Select a **CHANNEL** on switch.

Hold **P1** button on motor head.

Hold **STOP** on switch.

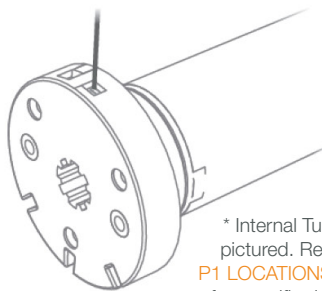
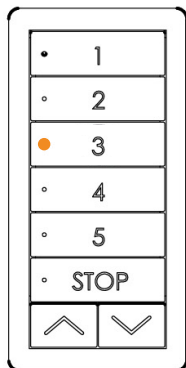

* Internal Tubular pictured. Refer to **P1 LOCATIONS** below for specific devices.

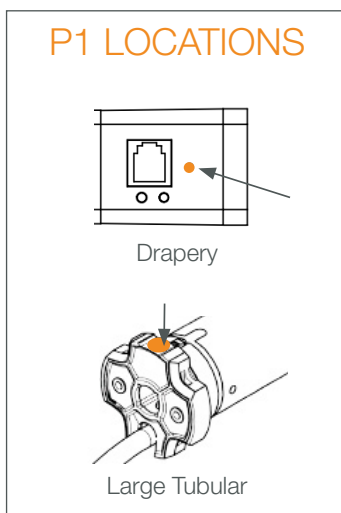
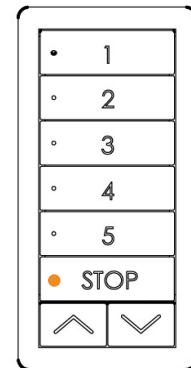

Motor Response

RELEASE P1



Motor Response



USING PRE-EXISTING CONTROLLER

A = Existing switch or channel (to keep).

B = Switch or channel to add or remove.

Select channel that operates motor on existing switch.
Press **P2**.

Press **P2** a second time on existing switch.

Select desired channel on new switch.
Press **P2** on new switch.

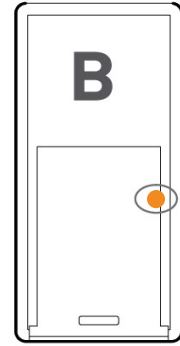
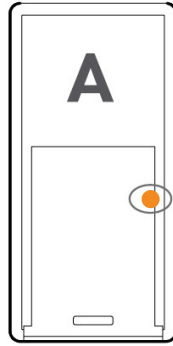
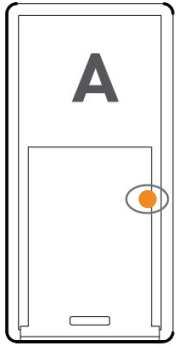

Motor Response



Motor Response



Motor Response



INITIAL SET UP

CHECK MOTOR DIRECTION

To check travel direction of shade, press **UP** or **DOWN** on the controller.

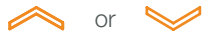

Quick Press = Step
Long Press = Continuous Travel

To reverse shade direction, hold both **UP** and **DOWN** until the motor responds.



Motor Response
Approx.   **JOG X1**



IMPORTANT

Damage to shade may occur when operating motor prior to setting limits. Attention should be given.



IMPORTANT

Reversing motor direction using this method is only possible during initial set up.

Direction change will not occur if switch is locked. See [page 11](#).

SET LIMITS

Move shade to the desired highest or lowest position by pressing the **UP** or **DOWN** on the controller.



To save upper limit, hold **UP** and **STOP**.

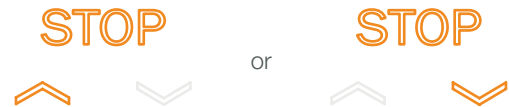

To save lower limit, hold **DOWN** and **STOP**.



IMPORTANT

Cycle shade up and down prior to setting limits to settle fabric

Initial set up is not complete yet.

Motor Response
Approx.    **JOG X2**
 **BEEP X3**



IMPORTANT

After setting limits, motor will automatically exit from initial set up mode.



IMPORTANT

For FT Motors, the bottom limit should be set ~ 1.38 in. (35mm) below the Ultra-Lock to disengage the auto lock mechanism when the shade is raised.

LOCKING THE LIMIT SETTING FUNCTION

Stops unwanted changes to limit settings.

Press **STOP** and hold for 15 seconds.

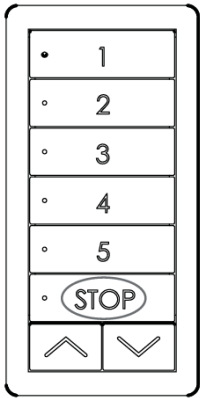

Release **STOP** button.
Locked limit settings.

Response

All lights flash x 1

Press **STOP** and hold for 15 seconds.

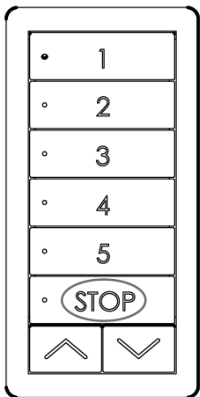

Release **STOP** button.
Unlocked limit settings.

Response

All lights flash x 2



IMPORTANT

The locked setting will prevent any multi-button functions. These include reversing direction before setting limits, limit setting and toggling between tilt and roller modes.

ADJUSTING LIMITS

ADJUST UPPER LIMIT

Hold **UP** and **STOP** on the controller.

Move shade to the desired highest position by pressing the **UP** button.

To save upper limit, hold **UP** and **STOP**.



Motor Response



Motor Response



ADJUST LOWER LIMIT

Hold **DOWN** and **STOP** on the controller.

Move shade to the desired lowest position by pressing the **DOWN** button.

To save lower limit, hold **DOWN** and **STOP**.



Motor Response



Motor Response



IMPORTANT

For FT Motors, the bottom limit should be set ~ 1.38 in. (35mm) below the Ultra-Lock to disengage the auto lock mechanism when the shade is raised.

FAVORITE POSITIONING

SET A FAVORITE POSITION

Move shade to the desired position by pressing the **UP** or **DOWN** button on the controller.

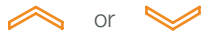

Press **P2** on controller.

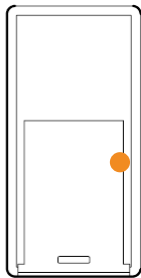

Press **STOP** on controller.

STOP



Press **STOP** on controller.

STOP



Motor Response



Motor Response



Motor Response



SEND SHADE TO FAVORITE POSITION

Press **STOP** on controller for 2 seconds.

STOP

DELETE A FAVORITE POSITION

Press **P2** on controller.

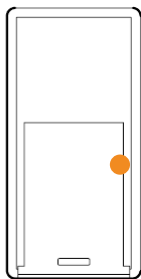

Press **STOP** on controller.

STOP

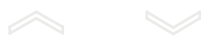

Press **STOP** on controller.

STOP



Motor Response



Motor Response



Motor Response



TROUBLESHOOTING

Problem	Cause	Remedy
Motor is not responding	Switch battery is discharged	Replace battery.
	Battery is inserted incorrectly	Check battery polarity.
	Radio interference / Shielding	Ensure switch is positioned away from metal objects and that aerial on motor or receiver is kept straight and away from metal.
	Receiver distance is too far from switch	Move switch to a closer position.
	Power failure	Check power supply to motor is connected and active.
	Incorrect wiring	Check wiring is connected correctly (refer to motor installation instructions).
Cannot set limits on a single motor (multiple motors respond)	Using channel "0" to adjust motor limits	Always reserve an individual channel for programming functions.
		SYSTEM BEST PRACTICE - Provide an extra 15 channel switch in your multi motor projects, that provides individual control for each motor for programming purposes.
Motor will not go down after setting the top limit	Top limit was set using the DOWN and STOP buttons	Reset the motor and begin programming sequence again. Remember the upper limit is to be set using the UP and STOP buttons, and the down limit is set using the DOWN and STOP buttons.
Motor will pair, but can not set limits	Switch is in a locked state. Control must be unlocked to set limits or perform any multi button functions	Press and hold STOP button for 15 seconds, until locked state changes.

Any Questions?

Contact our R-TEC Automation® in-house experts at 866.985.3423. Email us at RTECAutomation@RowleyCompany.com.