

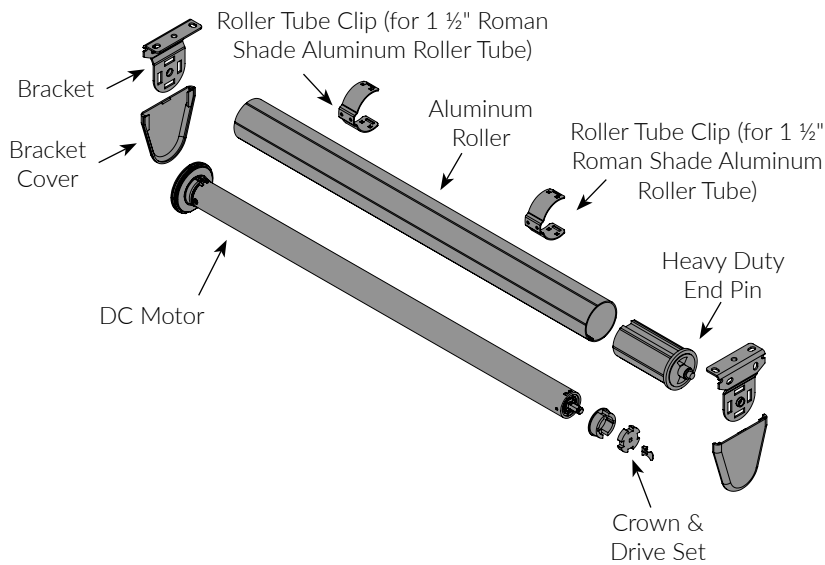

R-TEC DC SOFT SHADE SYSTEMS



ADDITIONAL OPTIONS

- Motor End Covers
- R-TEC Smart Controls

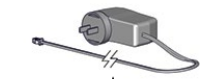

Power Solutions & Extension Cables



1 Channel Handheld Remote with Wall Mount

1 – CHOOSE YOUR SHADE QUANTITY

Let our in-house experts know how many shades to assemble.

2 – CHOOSE YOUR SHADE WEIGHT

Shade Weight determines Motor Size. Up to 13 lbs. or up to 23 ½" lbs.

3 – CHOOSE YOUR LIFTING MATERIAL

Select from Encased Lift Cord Tube or 6" Lift Band.

**Builds do not include Lift Cord or Lift Band. Remember to order Lift Cord or Lift Band.*

4 – CHOOSE YOUR SHADE DIMENSIONS

Maximum size for 13 lb. system is 84" x 84". Minimum shade width is 18".

Maximum size for 23 ½ lb. system is 120" x 120". Minimum shade width is 23 ½".



5 – CHOOSE YOUR LIFTING MATERIAL SPECIFICATIONS

Select the Number of Columns of lifting material on the shade. Indicate the distances between each column. Minimum spacing for Lift Band = 8"; Encased Lift Cord = 7".

6 – CHOOSE YOUR SHADE MOUNTING

Select Front / Standard or Reverse Mount, as well as Motor Placement Left or Right.

7 – CHOOSE YOUR MOTOR POWER & ACCESSORIES

Select from Power Supplies, or a Battery Tube/Pack with optional Eco Friendly Solar Panel Battery Charger.

8 – CHOOSE YOUR R-TEC SMART CONTROLS

System includes Handheld 1 Channel Remote. Take your shade control to the next level by upgrading to the R-TEC Hub to integrate your shades with whole home and voice control systems.

R-TEC DC SOFT SHADE SYSTEM

Encased Lift Cord or 6" Lift Band | BUILDS DO NOT INCLUDE LIFT CORD OR LIFT BAND

REV January 1, 2024

12" cords are only included to show the correct routing

Systems are built with 1 1/2" diameter roller tube

ACCOUNT #



Company _____	Contact _____	Date _____
Street Address _____	Person to contact with technical questions _____	
City _____	State _____	Zip _____ PO _____ Phone _____
Email _____ (required for shipping confirmation)		
Ship to (if different from above) _____ Attn _____		
Street Address _____	City _____	State _____ Zip _____

PLEASE COMPLETE ITEMS 1 THROUGH 9.

For assistance, call Customer Service at 866.985.3423.

Email completed form to rtecautomation@RowleyCompany.com.

1	Total number of shades to be made to these specifications	→ <input type="text"/>	(Use another order form for shades with different specifications)
2	SHADE WEIGHT: Include the weight of the fabric, lining, stiffeners & bottom weights.	<input type="checkbox"/> UP TO 13 LBS. 25 mm motor size CSRTMDCZ25112 (On 1 1/2" tube) <input type="checkbox"/> UP TO 23 1/2 LBS. 28 mm motor size CSRTMDCZ28112 (On 1 1/2" tube)	2 1/4" WIDTH BRACKETS INCLUDED 1 3/8" Proj. RSB10 SEE ALL BRACKETS FOR COMPARISON » 
3	TYPE OF LIFTING MATERIAL	<input type="checkbox"/> ENCASED LIFT CORD TUBE	<input type="checkbox"/> 6" LIFT BAND
4	EXACT SHADE DIMENSIONS in inches. We do not make any additional deductions. Maximum size for 13 lb. system is 84" x 84". Minimum shade width is 18". Maximum size for 23 1/2 lb. system is 120" x 120". Minimum shade width is 23 1/2".	WIDTH ← →	Dustboard size 3/4" x 2 1/2"
5	NUMBER OF COLUMNS OF LIFTING MATERIAL ON THE SHADE. INDICATE THE DISTANCES BETWEEN EACH COLUMN OF LIFTING MATERIAL ON THE SHADE. Minimum spacing for Lift Band = 8"; Encased Lift Cord = 7". Your headrail will be built according to the measurements you provide on the chart below. Your sketch doesn't have to be to scale, but THE NUMBERS MUST BE ACCURATE to the nearest 1/8". Draw vertical lines to show the columns of Encased Lift Cord. Be sure to include every column, including those close to the edges of the headrail. The first two columns are sketched for you. Write the measurements to indicate the distance between each column of Encased Lift Cord and the next. CHECK THAT THESE MEASUREMENTS ADD UP TO THE EXACT SHADE WIDTH IN ITEM 4.		
<div>← →</div> <div>← 2" → Minimum 2" from the end on each side. EXAMPLE 2" 10" 10" 2" = (24" Headrail) ← 2" →</div>			
6	SHADE MOUNTING: Shades are typically mounted over the front of the operating system. Indicate if you plan to mount to the back of the operating system by checking the box. No additional charge.	<input type="checkbox"/> FRONT MOUNT STANDARD <input type="checkbox"/> REVERSE MOUNT <input type="checkbox"/> MOTOR LEFT <input type="checkbox"/> MOTOR RIGHT	

*ACCESSORIES & R-TEC SMART CONTROLS BELOW IN ITEMS 7 & 8 SOLD SEPARATELY.

7	ACCESSORIES* Requires Battery Tube, Battery Pack or Power Supply.	<input type="checkbox"/> BATTERY TUBE \$33.00 (use with 25 mm motor only) <input type="checkbox"/> SOLAR PANEL \$120.00	<input type="checkbox"/> RECHARGEABLE BATTERY PACK \$95.32 <input type="checkbox"/> BATTERY CHARGER (Required) \$8.49 <input type="checkbox"/> CHARGER CABLE EXTENDER 48" \$8.57	<input type="checkbox"/> POWER SUPPLY 5' \$38.50 <input type="checkbox"/> POWER CABLE EXTENDER 48" \$5.50 <input type="checkbox"/> POWER SUPPLY 10 1/2' \$82.50 <input type="checkbox"/> POWER CABLE EXTENDER 48" \$5.50
8	R-TEC SMART CONTROLS*	1 control required for shade system to function. 1 channel remote included, select alternative remote option for additional charge. HANDHELD REMOTE (1 Channel, 65' Range) Optional add-on controls <input type="checkbox"/> WI-FI TO ARC BRIDGE HUB, 2-WAY RF \$255.00 (60' Range)	HANDHELD REMOTE OPTIONS 65' Range <input type="checkbox"/> Push 5 white \$70.00 <input type="checkbox"/> Push 15 Ch white \$75.00 <input type="checkbox"/> Push 15 Ch black \$75.00 <input type="checkbox"/> 15 Ch white \$85.00 <input type="checkbox"/> ARC USB SIGNAL REPEATER \$120.00 (Extends the wireless range of the R-TEC Hub and Remotes up to 60') <input type="checkbox"/> WALL CHARGER \$8.49	CUT-IN MOUNT SWITCH OPTIONS 65' Range, Requires RTMSMB/W \$8.50 <input type="checkbox"/> 1 Ch white \$50.64 <input type="checkbox"/> 2 Ch white \$56.59 <input type="checkbox"/> 15 Ch white \$75.00 <input type="checkbox"/> INTERIOR SUN SENSOR \$45.00 (65' Range) <input type="checkbox"/> SURFACE MOUNT WALL SWITCH \$70.00 (5 Channel, 65' Range)

9 READ THE TERMS OF SALE on the Custom Solutions Payment Form on page 3, sign and submit along with your signed forms.

*Builds do not include Lift Cord or Lift Band. Remember to order Lift Cord or Lift Band.

SHIPPING » [Flat Rate Shipping Program](#) Lengths over 8' will ship truck and incur an oversized fee. Splicing options for overlength sizes and alternative freight quotes available.

PRICING »

Rowley® Company
230 Meek Road / Gastonia / NC / 28056
Phone » R-TEC Automation® 866-985-3423
© 2024 Rowley® Company, LLC

Signature of purchaser / cardholder





Date

PAYMENT FORM

ACCOUNT #

To place a Custom Solutions Shade System, Drapery Hardware System or Label order, you must complete and sign the Payment Form along with the applicable system build form. You may submit your completed forms via email to Sales@RowleyCompany.com.

For Order Forms, visit RowleyCompany.com/CustomSolutions

<input type="radio"/> OVERNIGHT SHIPPING (additional freight will apply)		SHIPPING » Flat Rate Shipping Program Lengths over 8' will ship truck and incur an oversized  fee. Splicing options for overlength sizes and alternative freight quotes available.	
SELECT ONE <input type="radio"/>  <input type="radio"/>  <input type="radio"/>  <input type="radio"/> 		EXPIRATION DATE <div style="border: 1px solid black; width: 100px; height: 25px; margin: 0 auto;"></div>	
CREDIT CARD # - LAST 4 DIGITS <div style="border: 1px solid black; width: 100px; height: 25px; margin: 0 auto;"></div>		SECURITY CODE <div style="border: 1px solid black; width: 100px; height: 25px; margin: 0 auto;"></div>	
I authorize Rowley® Company to charge the credit card above for all of my orders submitted to Rowley® Company. I have read, understood and agree to the Terms of Sale on this payment form.		Visa, MC, Discover: 3 digits AMEX: 4 digits	
<div style="border: 1px solid black; padding: 10px;"> <p style="text-align: center;">Credit Card Billing Address (if different than ship to address)</p> <p>_____</p> <p>Complete Name of Card Holder</p> <p>_____</p> <p>Street Address</p> <p>_____</p> <p>City _____ State _____ Zip _____</p> <p>_____</p> <p>Phone</p> <p>_____</p> <p>Email</p> <p>_____</p> </div>		<div style="border: 1px solid black; padding: 10px;"> <div style="display: flex; align-items: center;"> <input style="width: 40px; height: 20px; margin-right: 5px;" type="checkbox"/> <div> Ship and apply to my pre-approved Net 30 account. Account # _____ </div> </div> <p>The price of the custom build includes all parts, labor and packaging, but does not include sales tax where applicable or shipping charges, for which the receiver is responsible. All orders will ship within five business days from confirmation of order with satisfactory payment arrangements. R-TEC Automation® orders will ship within 10 - 15 business days. For commercial orders, request a quote with timeline. Terms: Net 30 days to pre-approved accounts only or credit card. Prices, design and availability are subject to change or withdrawal without notice.</p> </div>	
_____ Signature of purchaser / cardholder		_____ Date	

TERMS OF SALE

WARRANTIES BY ROWLEY® COMPANY

Rowley® Company agrees to repair or replace, free of charge, any Custom Solutions Shade or Track System that due to faulty parts or workmanship in the assembled Shade or Track System is returned freight pre-paid to Rowley® Company within ninety (90) days of delivery. The parts in the system are covered by a ten year warranty. These warranties do not cover systems that have been subjected to abuse. The R-TEC Automation® Slim Drapery Motor is covered by a 5 year warranty.

Orders for Custom Solutions Label, Shade or Track Systems are not cancelable and cannot be altered. Custom Solution Label, Shade or Track Systems are not returnable for any reason except warranty repair, as described above. The buyer verifies that all sizes and other specifications are correct. A Custom Solutions Shade or Track System will be custom-built to the size and other specifications written on the system order form. Rowley® Company will repair or replace without charge any Custom Solutions Shade or Track System that is not made correctly to those specifications. THE CUSTOMER WILL BE CHARGED FOR ANY REPAIRS OR REPLACEMENT NECESSITATED BY AN ERROR IN THE MEASUREMENT OR OTHER SPECIFICATIONS.

OWNERSHIP: All selected shipping preferences are F.O.B. shipping point from any Rowley® location; the buyer owns the shipment as soon as it leaves the Rowley® Company loading dock. In the event of damaged shipment, the buyer must accept the shipment and place a claim with the carrier. Prices quoted include all parts, labor and packaging for all Custom Solutions Shade or Track Systems. The buyer is responsible for shipping costs.



Rowley® Company
 230 Meek Road / Gastonia / NC / 28056
 Phone » toll-free 800-343-4542 or local 704-866-0650
 © 2024 Rowley® Company, LLC