

# RTAWR1CV1W & RTAWR2CV1W LED Wall Mount Remotes User Manual

## 1. PRODUCT DIAGRAM

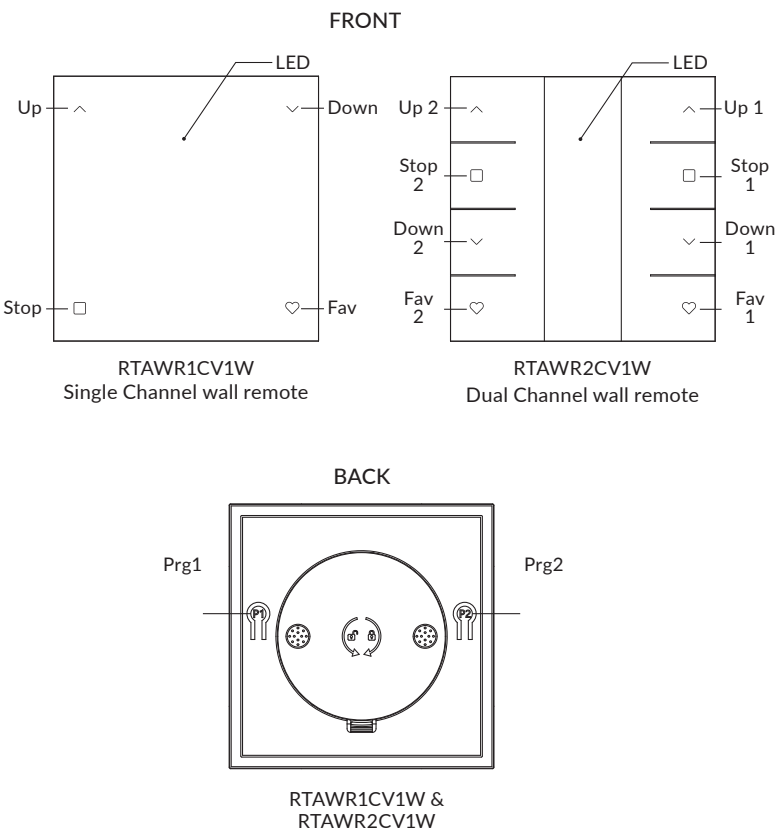

## 2. REMOTE SPECIFICATIONS

Battery Type	CR2430*3V*2
Working Temperature	14°-122°F
Radio Frequency	433.92M <sup>±</sup> 100KHz
Transmit Distance	>=98.5' indoor

## 3. CAUTION

**WARNING:** Important safety and operation instructions to be read before installation and use.

1. This product is intended for indoor use only. Do not expose the remote to moisture or extreme temperatures.
2. If the remote becomes less responsive and has a shorter transmission range, please check whether the battery needs to be replaced.
3. Use or modification outside the scope of this instruction manual will void warranty.
4. When the battery voltage is too low, the orange LED will flicker during operation.
5. Please properly dispose of used batteries and replace with only the specified battery type.

## WARNING

- **INGESTION HAZARD:** This product contains a button cell or coin battery
- **DEATH** or serious injury can occur if ingested.
- A swallowed button cell or coin battery can cause **Internal Chemical Burns** in as little as **2 hours**.
- **KEEP** new and used batteries **OUT OF REACH of CHILDREN**
- **Seek immediate medical attention** if a battery is suspected to be swallowed or inserted inside any part of the body.



## 4. INSTRUCTIONS

Follow the motor pairing instructions for the single channel wall remote. For the dual channel wall remote follow the steps below:

**Dual Channel Wall Remote pairing only:**

**For pairing a motor(s) with the dual channel wall remote on channel 1:**

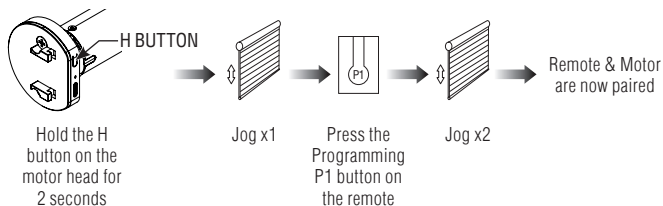

**To add an additional motor B:**

To add an additional motor to the same channel follow the steps above for motor B.

**For pairing a motor(s) with the dual channel wall remote on channel 2:**

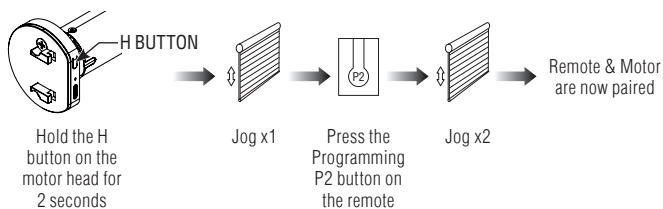

Note: A maximum of 15 motors can be added to one channel. All motors added to the same channel will operate simultaneously.

See motor pairing instructions first before completing the following steps below.

**LOCKING THE REMOTE:** Prohibits any programming or settings from being changed on the Remote.

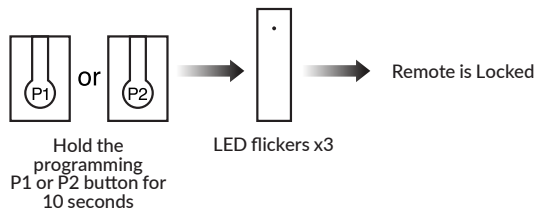

To unlock the remote and allow programming once again, repeat the steps above. For further operations please refer to the motor pairing instructions.